



# POKENO VILLAGE

E S T A T E



192m<sup>2</sup> - 4 bedrooms + rumpus room - 2 bathrooms - double garage

**HOUSE & LAND PACKAGE FROM \$549,000\***

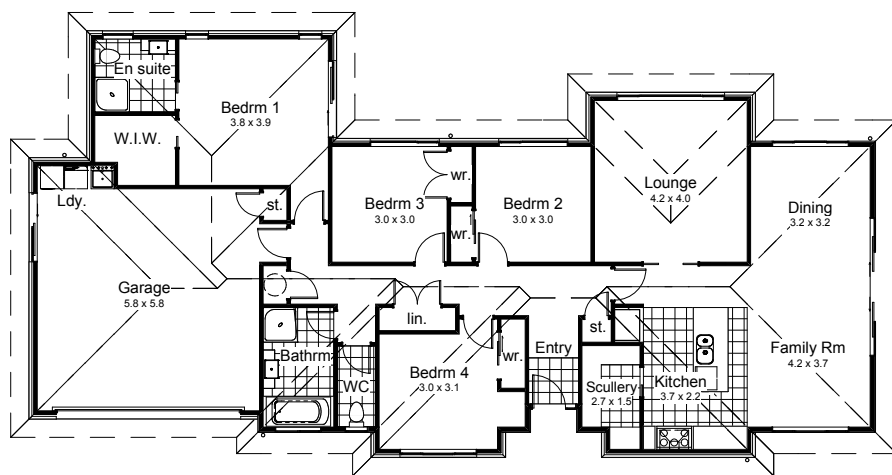

Our Quality range of homes are designed for smaller sections or for those wanting big home comfort and practicality on a smaller scale. These homes fit the description for pretty much every New Zealander who needs a home to grow up in, grow a family in, or grow old in. They offer all the essentials and much, much more. The quintessential kiwi home!

This package incorporates a spacious 4 bedroom house that comes complete with a separate toilet for the kids or visitors. And a rumpus room for entertaining. The kitchen includes a great range of modern Bosch appliances, accessories and scullery. The master bedroom comes complete with ensuite and walk in wardrobe. Topped off with a spacious Patio area and ample Landscaping.

#### Gladwin Homes commitment to its clients

- Built with Award Winning Master Builders
- Fixed price
- No hidden extras
- 10 Year Master Builders Guarantee

\*Construction of this home starting Jan 2014: Cnr of Crosshill Crt and Kilbryde Crs, Pokeno.

\*Package price is based on a level 600m<sup>2</sup> section within Pokeno Village Estate. Variations in section size, materials and building costs may result in changes in the package price. Designs and drawings are artist's impressions only and may not necessarily reflect the materials the package price is based on. All designs and illustrations are the copyright of Gladwin Homes. Gladwin Homes Ltd offer Design and Build Service for Clients on their section or one of ours.

**For more designs and specific information on other house & land packages contact Ian:**

Ian Denning - 021 915 186 | 0800 769252  
[gladwinhomes@xtra.co.nz](mailto:gladwinhomes@xtra.co.nz)

  
**GLADWIN HOMES LTD**  
Building in Excellence