

I, MICHAEL STEPHEN SMITH, MIPENZ CPENG HEREBY BELIEVE ON ALL REASONABLE GROUNDS THAT THE PIPE SIZES, FITTINGS, POSITIONS, COORDINATES AND LEVELS SHOWN ARE ACCURATELY PLOTTED IN RELATION TO BOUNDARIES AND IS CORRECT AS THIS INFORMATION HAS BEEN PROVIDED BY THE CONTRACTOR OF THE WORKS - KERRY DINES LTD.

MICHAEL STEPHEN SMITH DATE
MIPENZ CPENG

LEGEND			
	MANHOLE		EX.MANHOLE
	OUTLET		EX.CATCHPIT
	CATCHPIT		EX.SW LINE
	SW LINE		

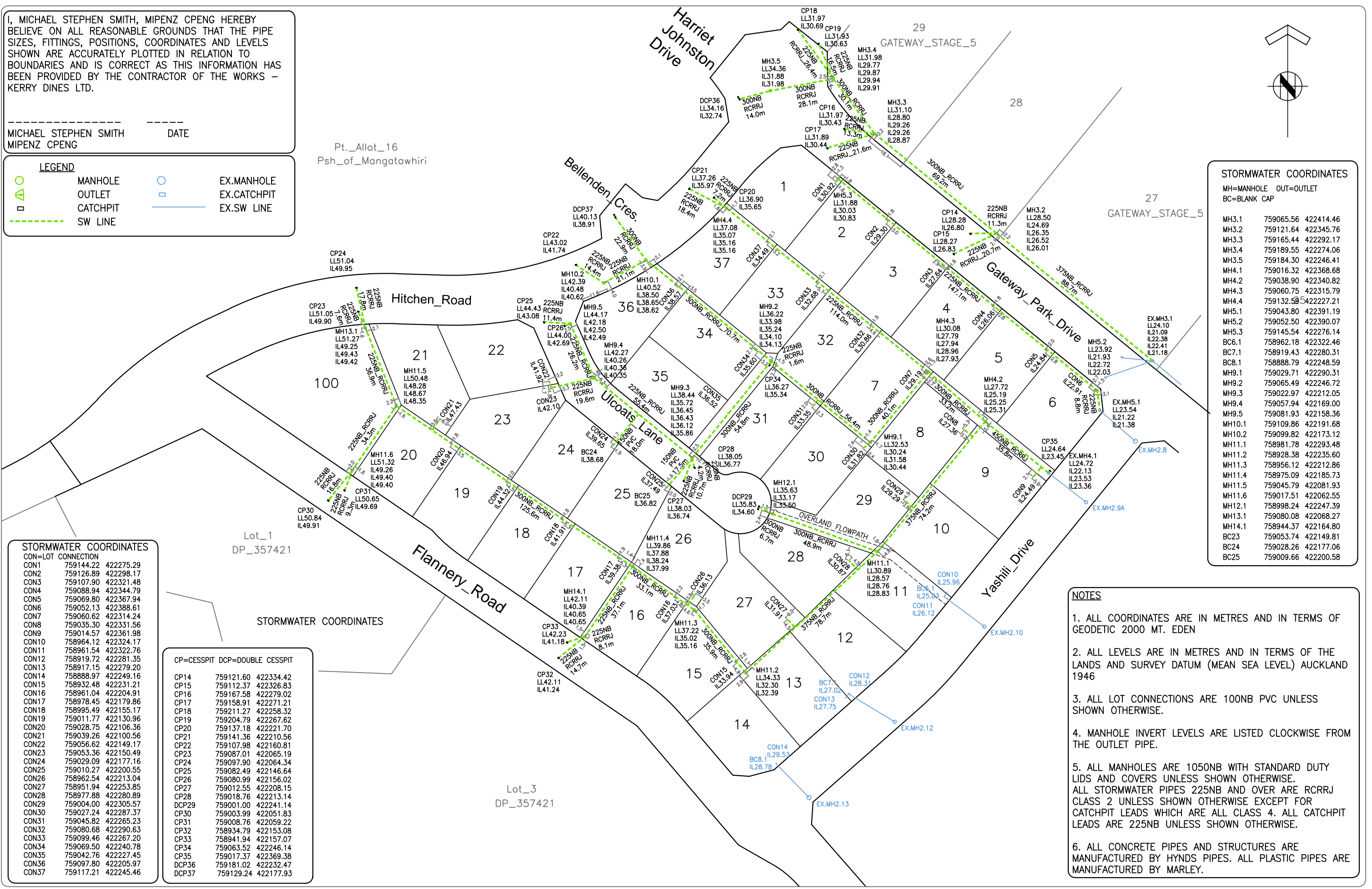

STORMWATER COORDINATES			
MH=MANHOLE	OUT=OUTLET	BC=BLANK CAP	
MH3.1	759065.56	422414.46	
MH3.2	759121.64	422345.76	
MH3.3	759165.44	422292.17	
MH3.4	759189.55	422274.06	
MH3.5	759184.30	422246.41	
MH4.1	759016.32	422368.68	
MH4.2	759038.90	422340.82	
MH4.3	759060.75	422315.79	
MH4.4	759132.58	422227.21	
MH4.5	759043.80	422391.19	
MH5.1	759052.50	422390.07	
MH5.2	759145.54	422276.14	
BC6.1	758962.18	422322.46	
BC7.1	758919.43	422280.31	
BC8.1	758888.79	422248.59	
MH9.1	759029.71	422290.31	
MH9.2	759065.49	422246.72	
MH9.3	759022.97	422212.05	
MH9.4	759057.94	422216.00	
MH9.5	759081.93	422158.36	
MH10.1	759109.86	422191.68	
MH10.2	759099.82	422173.12	
MH11.1	758981.78	422293.48	
MH11.2	758928.38	422235.60	
MH11.3	758956.12	422212.86	
MH11.4	758975.09	422185.73	
MH11.5	759045.79	422081.93	
MH11.6	759017.51	422062.55	
MH12.1	758998.24	422247.39	
MH13.1	759080.08	422068.27	
MH14.1	758944.37	422164.80	
BC23	759053.74	422149.81	
BC24	759028.26	422177.06	
BC25	759009.66	422200.58	

STORMWATER COORDINATES			
CON=LOT CONNECTION			
CON1	759144.22	422275.29	
CON2	759126.89	422298.17	
CON3	759107.90	422321.48	
CON4	759088.94	422344.79	
CON5	759069.80	422367.94	
CON6	759052.13	422388.61	
CON7	759060.62	422314.24	
CON8	759035.30	422331.56	
CON9	759014.57	422361.98	
CON10	758964.12	422324.17	
CON11	758961.54	422322.76	
CON12	758919.72	422281.35	
CON13	758917.15	422279.20	
CON14	758888.97	422249.16	
CON15	758932.48	422231.21	
CON16	758961.04	422204.91	
CON17	758978.45	422179.86	
CON18	758995.49	422155.17	
CON19	759011.77	422130.96	
CON20	759028.75	422106.36	
CON21	759039.26	422100.56	
CON22	759056.62	422149.17	
CON23	759053.36	422150.49	
CON24	759029.09	422177.16	
CON25	759010.27	422200.55	
CON26	758962.54	422213.04	
CON27	758951.94	422253.85	
CON28	758977.88	422280.89	
CON29	759004.00	422305.57	
CON30	759027.24	422287.37	
CON31	759045.82	422265.23	
CON32	759080.68	422290.63	
CON33	759099.46	422267.20	
CON34	759069.50	422240.78	
CON35	759042.76	422227.45	
CON36	759097.80	422205.97	
CON37	759117.21	422245.46	

CP=CESSPIT	DCP=DOUBLE CESSPIT		
CP14	759121.60	422334.42	
CP15	759112.37	422326.83	
CP16	759167.58	422279.02	
CP17	759158.91	422271.21	
CP18	759211.27	422258.32	
CP19	759204.79	422267.62	
CP20	759137.18	422221.70	
CP21	759141.36	422210.56	
CP22	759107.98	422160.81	
CP23	759087.01	422065.19	
CP24	759097.90	422064.34	
CP25	759082.49	422146.64	
CP26	759080.99	422156.02	
CP27	759012.55	422208.15	
CP28	759018.76	422213.14	
DCP29	759001.00	422241.14	
CP30	759003.99	422051.83	
CP31	759008.76	422059.22	
CP32	758934.79	422153.08	
CP33	758941.94	422157.07	
CP34	759063.52	422246.14	
CP35	759017.37	422369.38	
DCP36	759181.02	422232.47	
DCP37	759129.24	422177.93	

NOTES

- ALL COORDINATES ARE IN METRES AND IN TERMS OF GEODETIC 2000 MT. EDEN
- ALL LEVELS ARE IN METRES AND IN TERMS OF THE LANDS AND SURVEY DATUM (MEAN SEA LEVEL) AUCKLAND 1946
- ALL LOT CONNECTIONS ARE 100NB PVC UNLESS SHOWN OTHERWISE.
- MANHOLE INVERT LEVELS ARE LISTED CLOCKWISE FROM THE OUTLET PIPE.
- ALL MANHOLES ARE 1050NB WITH STANDARD DUTY LIDS AND COVERS UNLESS SHOWN OTHERWISE. ALL STORMWATER PIPES 225NB AND OVER ARE RCRRJ CLASS 2 UNLESS SHOWN OTHERWISE EXCEPT FOR CATCHPIT LEADS WHICH ARE ALL CLASS 4. ALL CATCHPIT LEADS ARE 225NB UNLESS SHOWN OTHERWISE.
- ALL CONCRETE PIPES AND STRUCTURES ARE MANUFACTURED BY HYNDS PIPES. ALL PLASTIC PIPES ARE MANUFACTURED BY MARLEY.

REV	REVISION DETAILS	BY	DATE

PLOTTED: RJP DATE: 12-16 DRAWN: RJP DATE: 12-16 APPROVED: MSS DATE: 12-16	THIS DRAWING AND DESIGN REMAINS THE PROPERTY OF AND MAY NOT BE REPRODUCED OR ALTERED, WITHOUT THE WRITTEN PERMISSION OF CIVILPLAN CONSULTANTS LIMITED. NO LIABILITY SHALL BE ACCEPTED FOR UNAUTHORISED USE OF THIS DRAWING.
--	---

CIVILPLAN CONSULTANTS
 Level 3 AMI Building, 15 Osterley Way, Manukau City. Phone: 2222445

PROJECT TITLE: DFH JOINT VENTURE HITCHEN STAGE 1 SUBDIVISION POKENO

SHEET TITLE: AS BUILT STORMWATER

ISSUE STATUS: **AS BUILT**
 SCALE: (A1/A3) 1:750 / 1:1500
 DRAWING NUMBER: 136701-01-AB400
 Filepath: C:\DATA\POKENO\HITCHEN\STAGE 1\AS BUILT\136701-01-AB400.DWG

NOTES

1. ALL COORDINATES ARE IN METRES AND IN TERMS OF GEODETIC 2000 MT. EDEN
2. ALL LEVELS ARE IN METRES AND IN TERMS OF THE LANDS AND SURVEY DATUM (MEAN SEA LEVEL) AUCKLAND 1946
3. ALL LOT CONNECTIONS ARE 100NB PVC UNLESS SHOWN OTHERWISE.
4. MANHOLE INVERT LEVELS ARE LISTED CLOCKWISE FROM THE OUTLET PIPE.
5. ALL MANHOLES ARE 1050NB WITH STANDARD DUTY LIDS AND COVERS UNLESS SHOWN OTHERWISE.
6. ALL PIPES ARE MANUFACTURED BY MARLEY AND MANHOLES BY HYNDS PIPES.

LEGEND

- MANHOLE
- WW LINE
- EX.MANHOLE
- EX.WW LINE

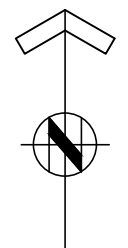

WASTEWATER COORDINATES

CON=LOT CONNECTION

CON1	759146.28	422274.46
CON2	759126.26	422298.94
CON3	759107.45	422322.38
CON4	759088.35	422345.60
CON5	759069.16	422368.70
CON6	759053.69	422387.01
CON7	759061.61	422313.06
CON8	759038.04	422333.03
CON9	759013.56	422363.70
CON10	758985.38	422343.38
CON11	758959.18	422321.96
CON12	758937.40	422302.94
CON13	758915.17	422279.12
CON14	758895.01	422256.24
CON15	758929.61	422232.21
CON16	758960.62	422205.88
CON17	758976.73	422181.90
CON18	758993.58	422157.14
CON19	759010.55	422132.22
CON20	759027.36	422107.45
CON21	759037.36	422103.00
CON22	759058.39	422149.37
CON23	759048.92	422154.68
CON24	759030.12	422179.50
CON25	759010.87	422199.19
CON26	758960.53	422213.27
CON27	758932.57	422236.27
CON28	758978.41	422281.23
CON29	759005.35	422305.15
CON30	759044.11	422340.96
CON31	759045.41	422265.43
CON32	759078.68	422291.96
CON33	759014.09	422202.36
CON34	759067.04	422240.74
CON35	759048.02	422225.35
CON36	759045.82	422265.23
CON37	759116.17	422245.93

WASTEWATER COORDINATES

MH=MANHOLE
BC=BLANK CAP
CON=LOT CONNECTION

MHF1	759056.57	422391.93
MHF2	759157.48	422268.02
MHF3	759176.55	422233.10
MHF4	759152.58	422217.25
MHF5	759131.97	422194.89
MHF6	759142.75	422179.50
MHG1	759037.04	422335.19
MHG2	759008.21	422311.56
MHG3	758932.57	422236.27
MHG4	758957.92	422215.76
MHG5	759034.86	422102.74
MHH1	759044.11	422340.96
MHH2	759100.04	422272.38
MHH3	759069.02	422246.91
MHH4	759014.09	422202.36
MHH5	759041.27	422168.95
BCH6	759061.46	422152.27
BC31	759045.82	422265.23
BC37	759100.05	422208.89

I, MICHAEL STEPHEN SMITH, MIPENZ CPENG HEREBY BELIEVE ON ALL REASONABLE GROUNDS THAT THE PIPE SIZES, FITTINGS, POSITIONS, COORDINATES AND LEVELS SHOWN ARE ACCURATELY PLOTTED IN RELATION TO BOUNDARIES AND IS CORRECT AS THIS INFORMATION HAS BEEN PROVIDED BY THE CONTRACTOR OF THE WORKS - KERRY DINES LTD.

MICHAEL STEPHEN SMITH DATE
MIPENZ CPENG

REV	REVISION DETAILS	BY	DATE

PLOTTED:	DATE:
RJP	12-16
DRAWN:	DATE:
RJP	12-16
APPROVED:	DATE:
MSS	12-16

THIS DRAWING AND DESIGN REMAINS THE PROPERTY OF, AND MAY NOT BE REPRODUCED OR ALTERED, WITHOUT THE WRITTEN PERMISSION OF CIVILPLAN CONSULTANTS LIMITED. NO LIABILITY SHALL BE ACCEPTED FOR UNAUTHORISED USE OF THIS DRAWING.

CIVILPLAN CONSULTANTS

Level 3 AMI Building, 15 Osterley Way, Manukau City. Phone: 2222445

PROJECT TITLE:
**DFH JOINT VENTURE
HITCHEN STAGE 1 SUBDIVISION
POKENO**

SHEET TITLE:
AS BUILT WASTEWATER

ISSUE STATUS: **AS BUILT**

SCALE: (A1/A3)
0 20 40 60 80 100m
1:750 / 1:1500

DRAWING NUMBER: **136701-01-AB401** REV:
Filepath: C:\DATA\POKENO\HITCHEN\STAGE 1\AS BUILT\136701-01-AB401.DWG