

STREET LIGHT COORDINATES			
	mN	mE	
SL43	759397.70	421640.72	TYPE A
SL44	759369.35	421587.45	TYPE A
SL45	759348.28	421548.16	TYPE A
SL46	759293.05	421577.00	TYPE A
SL47	759311.02	421631.28	TYPE A



I, MICHAEL STEPHEN SMITH, MIPENZ CPENG HEREBY BELIEVE ON ALL REASONABLE GROUNDS THAT THE LOCATIONS OF KERBS, CHANNELS, STREET LIGHTS AND FOOTPATHS ARE ACCURATELY PLOTTED IN RELATION TO BOUNDARIES AND IS CORRECT AS THIS INFORMATION HAS BEEN PROVIDED BY THE CONTRACTOR OF THE WORKS - KERRY DINES LTD.

 MICHAEL STEPHEN SMITH DATE
 MIPENZ CPENG

NOTES

1. ALL COORDINATES ARE IN METRES AND IN TERMS OF GEODETIC 2000 MT. EDEN
2. ALL LEVELS ARE IN METRES AND IN TERMS OF THE LANDS AND SURVEY DATUM (MEAN SEA LEVEL) AUCKLAND 1946

LEGEND

	STD. KERB		EDGE OF SEAL
	KERB & NIB		TRANSITION TO EXISTING
	MOUNTABLE KERB		STREET LIGHTS
	CHANNEL		DRIVEWAY
	FOOTPATH		
	CHIPSEAL ONLY		

STREET LIGHT DETAILS

TYPE A - 7.5m VICPOLE 125mm SQUARE SERIES COLUMN HOT DIPPED GALV, TWO PACT BLACK PAINT FINISH. CREE EDGE SQUARE SERIES XAL 1304C-UT LED LIGHT FIXTURE. 40 WATT LED (525MA DRIVER), TYPE 3M OPTICS

REV	REVISION DETAILS	BY	DATE

PLOTTED:	DATE:	07-18
DRAWN:	DATE:	07-18
APPROVED:	DATE:	07-18

THIS DRAWING AND DESIGN REMAINS THE PROPERTY OF, AND MAY NOT BE REPRODUCED OR ALTERED, WITHOUT THE WRITTEN PERMISSION OF CIVILPLAN CONSULTANTS LIMITED. NO LIABILITY SHALL BE ACCEPTED FOR UNAUTHORIZED USE OF THIS DRAWING.

CIVILPLAN
CONSULTANTS

Level 3 AMI Building, 15 Osterley Way, Manukau City. Phone: 2222445

PROJECT TITLE:
DFH JOINT VENTURE
HITCHEN STAGE 4B SUBDIVISION
POKENO

SHEET TITLE:
AS BUILT ROADING

ISSUE STATUS: **AS BUILT**

SCALE: (A1/A3)
0 20 40 60 80 100m
1:500 / 1:1000

DRAWING NUMBER: **136701-04B-AB301** REV:

Filepath: C:\DATA\POKENO\HITCHEN\STAGE 4\AS BUILTS\136701-04B-AB301.DWG

I, MICHAEL STEPHEN SMITH, MIPENZ CPENG HEREBY BELIEVE ON ALL REASONABLE GROUNDS THAT THE PIPE SIZES, FITTINGS, POSITIONS, COORDINATES AND LEVELS SHOWN ARE ACCURATELY PLOTTED IN RELATION TO BOUNDARIES AND IS CORRECT AS THIS INFORMATION HAS BEEN PROVIDED BY THE CONTRACTOR OF THE WORKS - KERRY DINES LTD.

MICHAEL STEPHEN SMITH DATE
MIPENZ CPENG

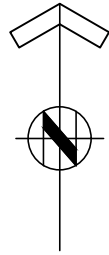

LEGEND	
	MANHOLE
	OUTLET
	CATCHPIT
	SW LINE
	EX. MANHOLE
	EX. CATCHPIT
	EX. SW LINE

- NOTES**
1. ALL COORDINATES ARE IN METRES AND IN TERMS OF GEODETIC 2000 MT. EDEN
 2. ALL LEVELS ARE IN METRES AND IN TERMS OF THE LANDS AND SURVEY DATUM (MEAN SEA LEVEL) AUCKLAND 1946
 3. ALL LOT CONNECTIONS ARE 100NB PVC UNLESS SHOWN OTHERWISE.
 4. MANHOLE INVERT LEVELS ARE LISTED CLOCKWISE FROM THE OUTLET PIPE.
 5. ALL MANHOLES ARE 1050NB WITH STANDARD DUTY LIDS AND COVERS UNLESS SHOWN OTHERWISE. ALL STORMWATER PIPES 225NB AND OVER ARE RCRRJ CLASS 2 UNLESS SHOWN OTHERWISE EXCEPT FOR CATCHPIT LEADS WHICH ARE ALL CLASS 4. ALL CATCHPIT LEADS ARE 225NB UNLESS SHOWN OTHERWISE.
 6. ALL CONCRETE PIPES AND STRUCTURES ARE MANUFACTURED BY HYNDS PIPES. ALL PLASTIC PIPES ARE MANUFACTURED BY MARLEY.

STORMWATER COORDINATES		
MH=MANHOLE, BC=BLANK CAP		
MH4.8	759264.57	421679.05
MH4.9	759227.48	421610.26
MH7.9	759365.09	421591.43
MH7.10	759342.93	421550.63
MH7.11	759315.74	421497.71
MH30.1	759332.71	421582.81
MH39.1	759321.94	421561.88
MH40.1	759315.31	421651.73
MH40.2	759269.27	421564.88

STORMWATER COORDINATES		
CP=CATCHPIT, DCP=DOUBLE CP		
CP51	759370.39	421587.67
CP51A	759377.50	421584.21
CP52	759324.58	421637.91
CP53	759317.57	421641.74
CP54	759345.46	421552.44

STORMWATER COORDINATES		
CON=LOT CONNECTION		
CON205	759312.01	421646.27
CON206	759303.38	421630.12
CON207	759295.28	421615.02
CON208	759286.21	421598.00
CON209	759278.21	421582.51
CON210	759315.78	421561.60
CON211	759328.42	421585.23
CON212	759335.50	421598.17
CON213	759344.87	421615.96
CON214	759355.20	421634.69
CON215	759364.82	421653.06
CON216	759375.04	421671.82
CON219	759400.42	421658.54
CON220	759391.51	421642.57
CON221	759382.69	421625.50
CON222	759373.05	421607.70
CON223	759362.86	421588.72
CON224	759353.02	421570.34
CON225	759340.89	421547.90



REV	REVISION DETAILS	BY	DATE

PLOTTED: RJP DRAWN: RJP APPROVED: MSS	DATE: 07-18 DATE: 07-18 DATE: 07-18
---	---

THIS DRAWING AND DESIGN REMAINS THE PROPERTY OF, AND MAY NOT BE REPRODUCED OR ALTERED, WITHOUT THE WRITTEN PERMISSION OF CIVILPLAN CONSULTANTS LIMITED. NO LIABILITY SHALL BE ACCEPTED FOR UNAUTHORISED USE OF THIS DRAWING.

CIVILPLAN CONSULTANTS
 Level 3 AMI Building, 15 Osterley Way, Manukau City. Phone: 2222445

PROJECT TITLE:
**DFH JOINT VENTURE
 HITCHEN STAGE 4B SUBDIVISION
 POKENO**

SHEET TITLE:
AS BUILT STORMWATER

ISSUE STATUS: **AS BUILT**

SCALE: (A1/A3)
 0 20 40 60 80 100m
 1:500 / 1:1000

DRAWING NUMBER: **136701-04B-AB402** REV:

Filepath: C:\DATA\POKENO\HITCHEN\STAGE 4\AS BUILT\136701-04B-AB402.DWG

NOTES

1. ALL COORDINATES ARE IN METRES AND IN TERMS OF GEODETIC 2000 MT. EDEN
2. ALL LEVELS ARE IN METRES AND IN TERMS OF THE LANDS AND SURVEY DATUM (MEAN SEA LEVEL) AUCKLAND 1946
3. ALL LOT CONNECTIONS ARE 100NB PVC UNLESS SHOWN OTHERWISE.
4. MANHOLE INVERT LEVELS ARE LISTED CLOCKWISE FROM THE OUTLET PIPE.
5. ALL MANHOLES ARE 1050NB WITH STANDARD DUTY LIDS AND COVERS UNLESS SHOWN OTHERWISE.
6. ALL PIPES ARE MANUFACTURED BY MARLEY AND MANHOLES BY HYNDS PIPES.



LEGEND

○	MANHOLE
—	WW LINE
○	EX.MANHOLE
—	EX.WW LINE

WASTEWATER COORDINATES
MH=MANHOLE, BC=BLANK CAP

MHC6	759211.86	421515.84
MHCC2	759319.85	421565.03
MHCC3	759253.07	421438.65
MHDD1	759333.45	421676.76
MHDD2	759273.66	421564.42

WASTEWATER COORDINATES
CON=CONNECTION

CON205	759310.65	421646.70
CON206	759303.71	421633.79
CON207	759294.62	421616.78
CON208	759286.12	421600.72
CON209	759277.50	421584.79
CON210	759316.18	421558.99
CON211	759329.16	421582.76
CON212	759339.00	421601.58
CON213	759348.66	421619.19
CON214	759358.10	421636.47
CON215	759367.15	421653.97
CON216	759376.62	421671.67
CON219	759399.49	421658.67
CON220	759389.44	421639.86
CON221	759380.31	421623.98
CON222	759370.30	421605.17
CON223	759361.77	421587.86
CON224	759353.22	421571.51
CON225	759340.58	421548.64

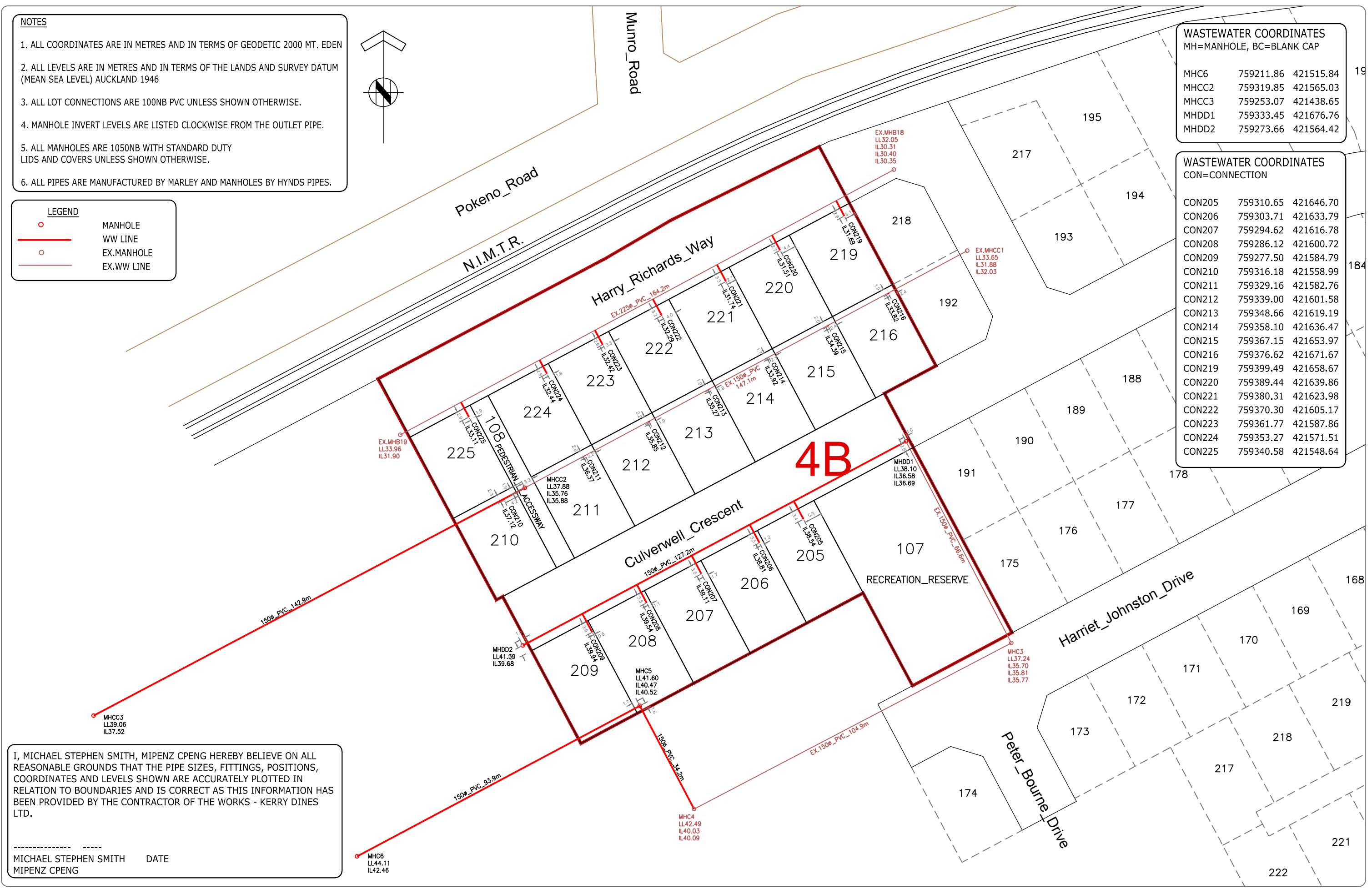

I, MICHAEL STEPHEN SMITH, MIPENZ CPENG HEREBY BELIEVE ON ALL REASONABLE GROUNDS THAT THE PIPE SIZES, FITTINGS, POSITIONS, COORDINATES AND LEVELS SHOWN ARE ACCURATELY PLOTTED IN RELATION TO BOUNDARIES AND IS CORRECT AS THIS INFORMATION HAS BEEN PROVIDED BY THE CONTRACTOR OF THE WORKS - KERRY DINES LTD.

MICHAEL STEPHEN SMITH DATE
MIPENZ CPENG

REV	REVISION DETAILS	BY	DATE

PLOTTED: RJP DRAWN: RJP APPROVED: MSS	DATE: 07-18 DATE: 07-18 DATE: 07-18	THIS DRAWING AND DESIGN REMAINS THE PROPERTY OF, AND MAY NOT BE REPRODUCED OR ALTERED, WITHOUT THE WRITTEN PERMISSION OF CIVILPLAN CONSULTANTS LIMITED. NO LIABILITY SHALL BE ACCEPTED FOR UNAUTHORISED USE OF THIS DRAWING.
---	---	--

CIVILPLAN CONSULTANTS

Level 3 AMI Building, 15 Osterley Way, Manukau City. Phone: 2222445

PROJECT TITLE:
**DFH JOINT VENTURE
HITCHEN STAGE 4B SUBDIVISION
POKENO**

SHEET TITLE:
AS BUILT WASTE WATER

ISSUE STATUS: **AS BUILT**

SCALE: (A1/A3)
0 20 40 60 80 100m
1:500 / 1:1000

DRAWING NUMBER: **136701-04B-AB403** REV: _____

Filepath: C:\DATA\POKENO\HITCHEN\STAGE 4\AS BUILT\136701-04B-AB403.DWG